

MB344SP User manual





Quad 2.5" HDD / SSD Bracket with Tool-less Drive Installation for 5.25" Bay

1

Package Contents • Packungsinhalt • Contenu • Contenido del paquete
包装について • 包装説明 • 包装说明

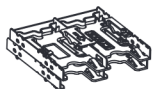

Bracket x 1



User manual x 1



M3*6 screws x 4 for bracket



(Optional) M2.5*7 screws x 3
for installing organizing rack

2

Installation Guide • Installationsanleitung • Guide d'Installation • Guía de instalación
製品の組み込み手順について • 操作步驟 • 操作步驟

1. Installing 2.5" HDD/SSD - Insert the 2.5" HDD/SSD until an audible 'click' indicates that the drive is installed securely.

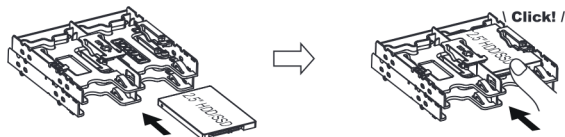

2. Removing 2.5" HDD/SSD - Simply eject the HDD/SSD by pressing the drive eject button and then pull out the drive.

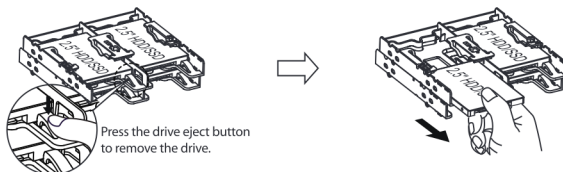

3. Device Installation - Use the included four screws to mount the FLEX-Fit Quattro into a 5.25" device bay with two screws on each side. Connect the power and data connectors to the installed drives to complete device installation.

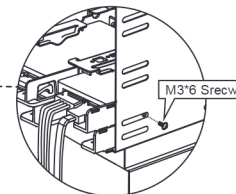
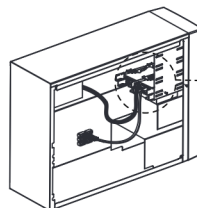

(Optional) Use FLEX-FIT Quattro as 2.5" HDD / SSD storage organizing rack

Flex-Fit Quattro can be used as a storage organizing rack. In addition, it can be expanded by stacking additional bracket on top of each other. (see below)

1. Two brackets are required to perform this installation.



2. Remove the pre-installed 3 x M2.5*7 screws from Set B to split into two bracket layers (B-1 & B-2). Please keep the removed 3 x M2.5*7 screws for installing bracket layers onto Set A)

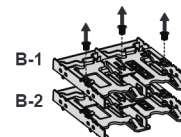
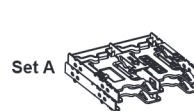

3. Use 3 x M2.5*7 screws to install B-1 onto Set A. To add more layers, simply place another bracket layer on top and secure it with 3 x M2.5*7 screws.

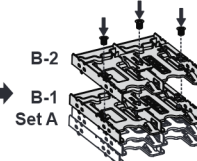
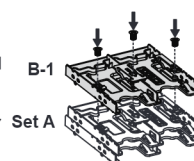

For more product information, please visit <http://www.icydock.com>